

Edwardian

AVANT GARDE

Price **Module 2**

Frontal: MDF Primed.

Standard Drawer: 500mm Silver powder coated drawer sides with full extension runners and Mfc base/back.

Price	Door Colour/Ref	Carcase Options-Mfc	Suggested Plinth Style (Charged separately)	Handle Options	Handle Centre	Handle Alignment On Hinged Door	Jig Ref.
2	Primed (84) For on-site painting.	Maple (35)	Primed (84)	205 Square Pewt Knob	16	V	AIC
				207 Gothic D	128	V	DID
				212 Walnut Knob	-	-	DID
				408 Engraved D	128	V	DID
				457 Rose Bud Pull	-	-	DID
				458 White Cracked Pewter	128	V	DID

Carcase Option

- A. If alternative carcass colour is required, this must be clearly stated on the order and apply to complete kitchens only. Options are - Alabaster, White, Light Oak, Maple, Silver, Milano Cherry Planked Walnut Mfc.
- B. When exposed T&G integral ends are required these should be specified as primed/solid colour T&G (Refer Section 7).



Primed 84 (white) for painting.

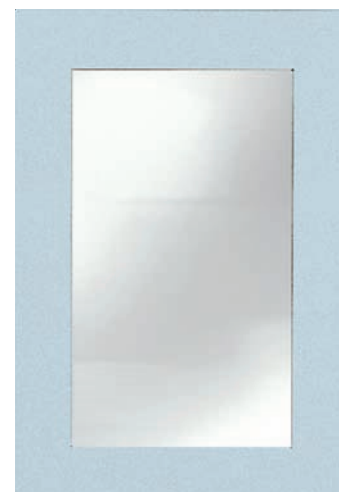

Glass Door.
Primed. Clear Glass.

Suggested Handle Choice



Square Pewter Knob. 205



Gothic D. 207



Walnut Knob. 212



Engraved D. 408



Rose Bud Pull. 457



White Cracked Pewter. 458

Premium Handles are available (see Section 0.42 and Section 8) and should be specified on order (extra charges apply per handle). Alternative standard handles are available. Please refer to Range/Standard handle availability chart (see Section 0.43 and Section 8).

Cornice

Model/Description	Colour (Ref.)
MLD011 Primed Cornice	Edwardian Primed (84)
MLD025 Primed Cornice/Edwardian Panel	Edwardian Primed (84)
*Alternative styles available (refer Section 6)	

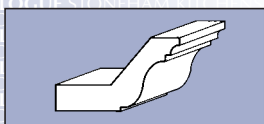

MLD 011

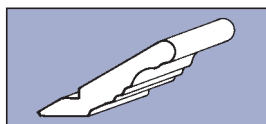

MLD 025

Pelmet Trim

Model/Description	Colour (Ref.)
MLD042 Primed Pelmet Trim	Edwardian Primed (84)
*Alternative styles available (refer Section 6)	

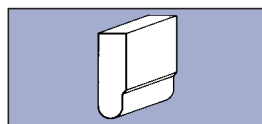

MLD 042